

# 2023 GUIDE TO COSTS & BENEFITS

## AT TEN TWENTY GROVE



TEN TWENTY GROVE  
PRESBYTERIAN HOMES





Ten Twenty Grove is a community of spirited people – who cherish their independence – and embrace life’s endless possibilities. The maintenance-free lifestyle presents a wealth of advantages. Cleaning house, shoveling snow and making repairs all become distant memories. You’ll discover more time for family and friends. You’ll be able to enjoy special interests, hobbies and passions in a home you can enjoy, rather than maintain.

The rental plan offers flexibility without a long-term commitment and provides priority access to the complete continuum of healthcare at Westminster Place but without the entrance fee.

### MONTHLY SERVICE FEES:

NAME	STYLE	SQUARE FOOTAGE	MONTHLY FEE
The Birch	1 Bedroom	700	\$2,225
The Aspen	2 Bedroom, 1.5 Bath	1,050	\$3,350
The Walnut	2 Bedroom, 1.5 Bath	1,100	\$3,495
The Maple	2 Bedroom, 2 Bath	1,400	\$4,460

### SERVICES AND AMENITIES:

- Indoor/Outdoor Maintenance
- Concierge/24 hour Security
- Underground Parking\*
- Housekeeping Services\*
- Scheduled Transportation\*
- Priority access to our renowned continuum of care at Westminster Place\*
- Utilities (except telephone and internet)
- Room with Fitness Equipment
- Library/Community Room

\* Available at an extra charge

Note: Services and pricing are subject to change. Ongoing access to these services and amenities is not guaranteed.

Presbyterian Homes’ mission is to serve older adults and their families. After you’ve reviewed our materials, let’s get together and discuss your questions or concerns.

**We look forward to hearing from you. Call us anytime at 847-641-2836.**



# THE ASPEN

# THE MAPLE

# THE ASPEN

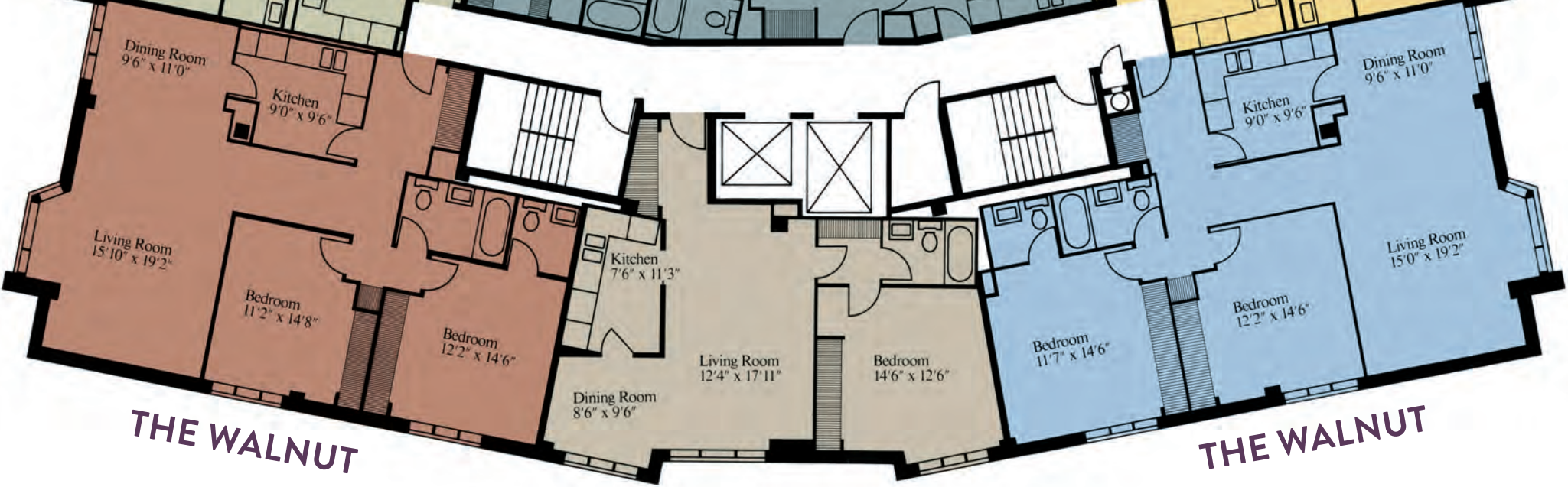
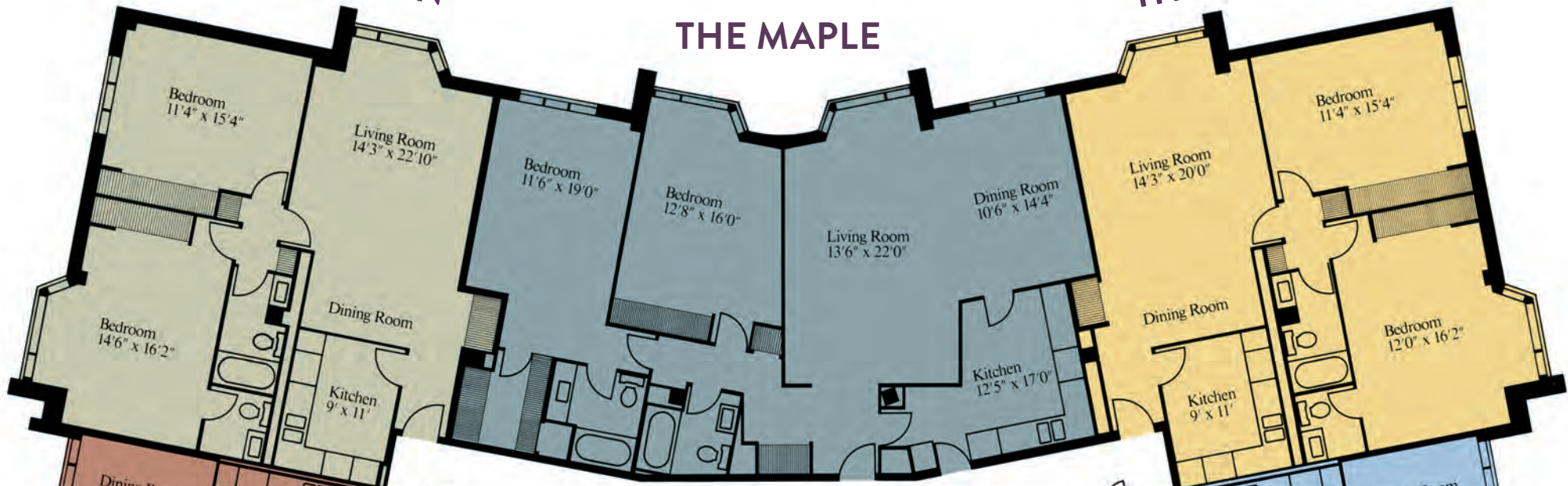

# THE WALNUT

# THE BIRCH

# THE WALNUT

*All dimensions are approximate.*



TEN TWENTY GROVE  
PRESBYTERIAN HOMES



# TEN TWENTY GROVE

PRESBYTERIAN HOMES

1020 Grove Street | Evanston, IL 60201

Phone: 847-570-3422

[www.TenTwentyGrove.org](http://www.TenTwentyGrove.org)